



*City of San Mateo's*

# CENTRAL PARK PLAYGROUND IMPROVEMENTS

**Playground Design Options  
Community Workshop #2**

*June 3, 2021*





# WELCOME!

★ **Friendly Reminder:**  
*This is a public meeting and conversations will be recorded. If you are uncomfortable being recorded, feel free to keep your camera off during the conversation.*

**Are you new to Zoom?** We can show you around.  
At the bottom of your screen, you will see these buttons:

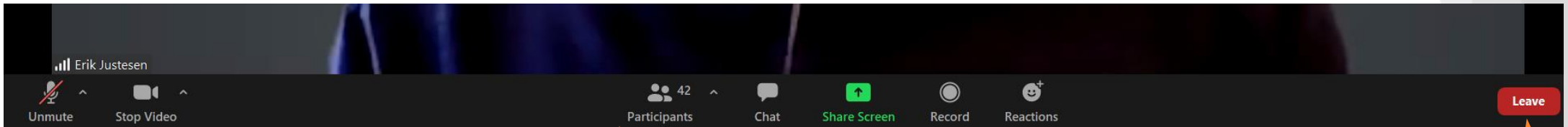

Unmute mic  
only when it  
is your turn  
to speak

Turn  
video on  
or off

**Raise your  
hand**  
Or, see who is  
in the meeting

You can send a  
*Chat* to message  
the facilitators

Click to  
leave  
meeting

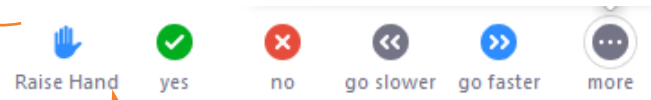

Raise Your Hand  
(on participants panel)

# AGENDA

---

- Master Plan Process Recap
- Outreach Summary
- Project Site
- Concept Designs
- Community Discussion & Survey
- Next Steps

# MASTER PLAN PROCESS

---

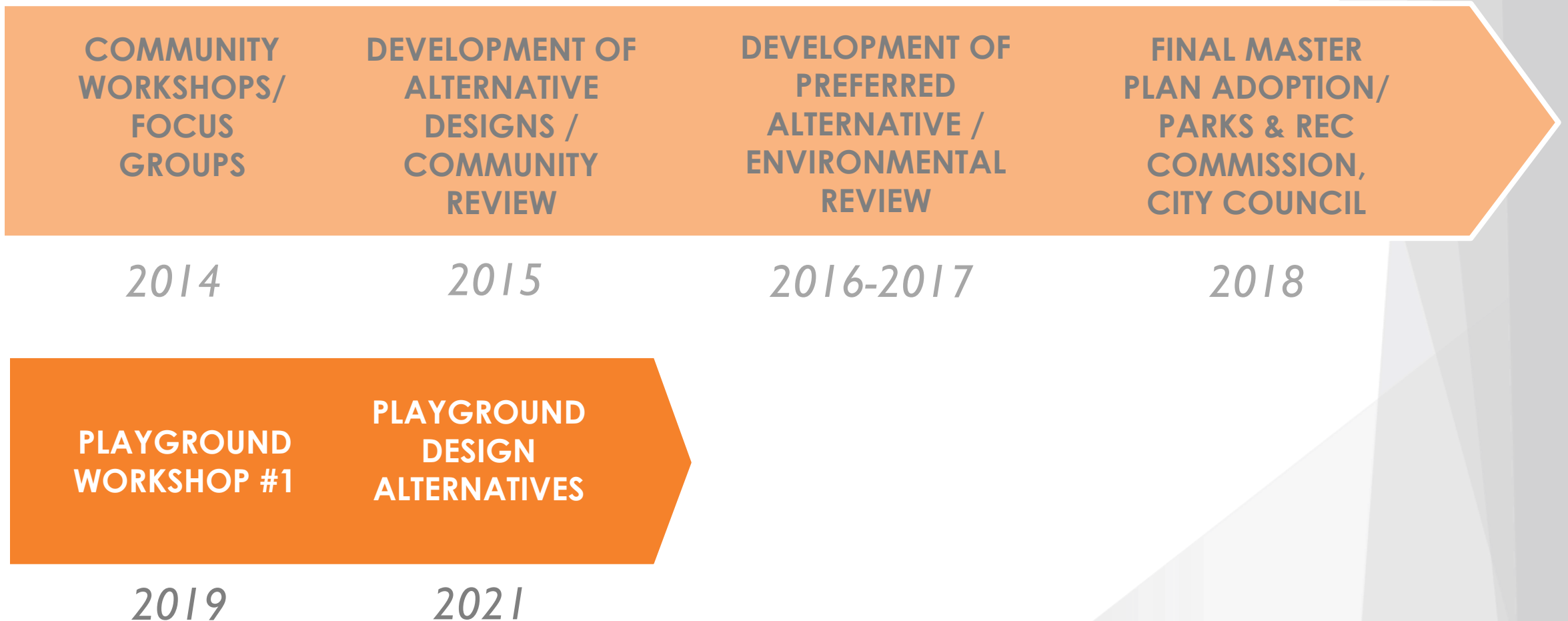



# ADOPTED MASTER PLAN

## KEY

1. Updated Park Signage
2. Existing Magnolias Remain
3. New Park Entry with Park Signage & Kohl-Style Fence
4. "Leon" Giraffe Sculpture
5. Kohl Mansion Footprint Interpretive Feature
6. Movable Bistro Tables, Typ.
7. Vendor Kiosks
8. Overhead String Lights
9. Staff/Service Parking & Temporary ADA Parking
10. Entry to Renovated Parking Garage (1-2 Levels)
11. Pedestrians Only
12. Crosswalk Aligned with Paseo
13. Down-sized Grandstand with Storefront Facade Improvements & Usable Community Space, Storage (such as Art Studios underneath)
14. Vehicle, Events & Maintenance Access
15. Widened Pedestrian Walk with Trees & Benches
16. Park Gateway Signage & Pedestrian Entry
17. Drought-Tolerant Perennials
18. Stepped Seating to Raised Turf Area
19. Plaza Benches, Typ.
20. Plaza Games Area (Ping Pong, Chess Tables, etc.)
21. Community Event Buildings (5,000 sf)
22. Ice Rink Electrical Equipment
23. Baseball Fencing
24. New Path
25. Turf Removal under Redwoods
26. Existing Pedestrian Access/Path
27. Existing Train Line
28. New Jim Chalmers San Mateo Rotary Picnic Pavilion (200-person capacity)
29. Picnic Shelter (existing park seating preserved)
30. Parking Structure Elevator
31. Parking Structure Stairwell
32. Controlled Vehicle Access
33. Pedestrian-Only Path
34. Loading/Unloading/Turn-around Area for Authorized Vehicles Only (with truncated domes encircling)
35. Future Site of Memorial for Fallen Heroes
36. Relocated Flag
37. Temporary Bandstand Location
38. Group Picnic Areas, Typ.
39. Playground (2-5 year-olds)
40. Playground (5-12 year-olds)
41. Natural Play Area
42. Park Gateway Signage (at historic entrance)
43. New Restroom with Storage
44. Individual Picnic Table, Typ.
45. Central Park Tennis Grounds (3 lighted courts)
46. Tennis Plaza with Benches & Picnic Tables
47. Existing Maintenance Garage
48. New Park Maintenance Storage Building
49. Historic Kohl Pumphouse & Garden
50. Greenhouse
51. Rose Garden
52. Park Gateway Signage
53. Dog Sculpture
54. Loading Zone/Staff Parking
55. Trash Enclosure
56. Bike Racks
57. Equipment Storage



**CENTRAL PARK MASTER PLAN**  
**FINAL MASTER PLAN**  
 SAN MATEO, CA.







# WORKSHOP #1



# OUTREACH SUMMARY

---

## Community Workshop #1

Central Park Playground October 5<sup>th</sup>, 2019

What we heard:

### SHOULD FEEL

*Safe  
Fun  
Clean*

### PRIORITIES

*Imaginative  
Inclusive  
Natural*

### FAVORITE PLAY ELEMENT

*Slides  
Swings  
Climbers*

### OTHER FEATURES

*Shade  
Seating  
Sensory*





# PROJECT SITE



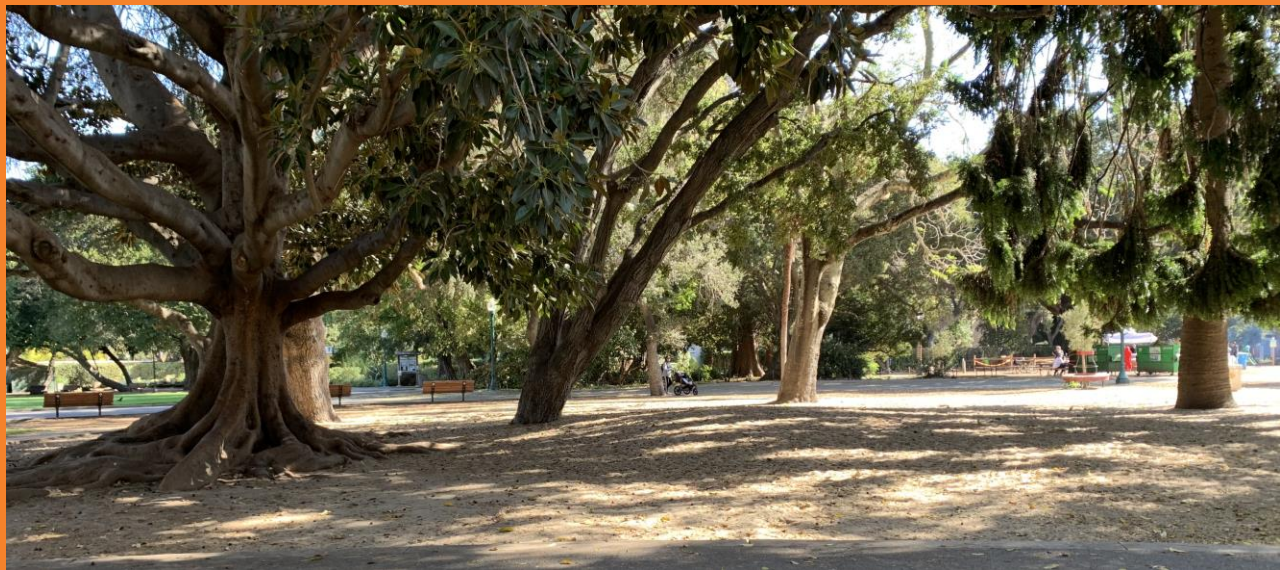

PROJECT SITE



# Adventure Village

# Playful History

The diagram is a hand-drawn site plan for a playground, titled "Playful History" in an orange box at the top left. The plan is centered around a "Kale Mahara Playhouse" which has a "Sand/Water Play" area directly below it. To the left of the playhouse is a "Carnegie House" and a "group Picnic Shelter". To the right is a long "Rainbow greenhouse" and a "Learning garden". The plan includes various play structures like "Spiral House of Fun", "Lower slides climber", and "group Picnic Shelter". It also shows "Existing Paths", "Existing Planting", "Existing Tennis Courts", and "New Earth Play Area Plan". The plan is surrounded by "Mudch Area" and "Plaster".

Key features and labels include:

- Playful History
- group Picnic Shelter
- group Picnic
- Mudch Area
- Plaster
- Restroom
- Spiral House of Fun
- Lower slides climber
- Learning garden
- Rainbow greenhouse
- Turf (Picture Tennis Courts)
- Plaster's
- Mudch Area
- Sand/Water Play
- Spiral & Spinner Zone
- Existing Paths
- Existing Planting
- Existing Tennis Courts
- New Earth Play Area Plan

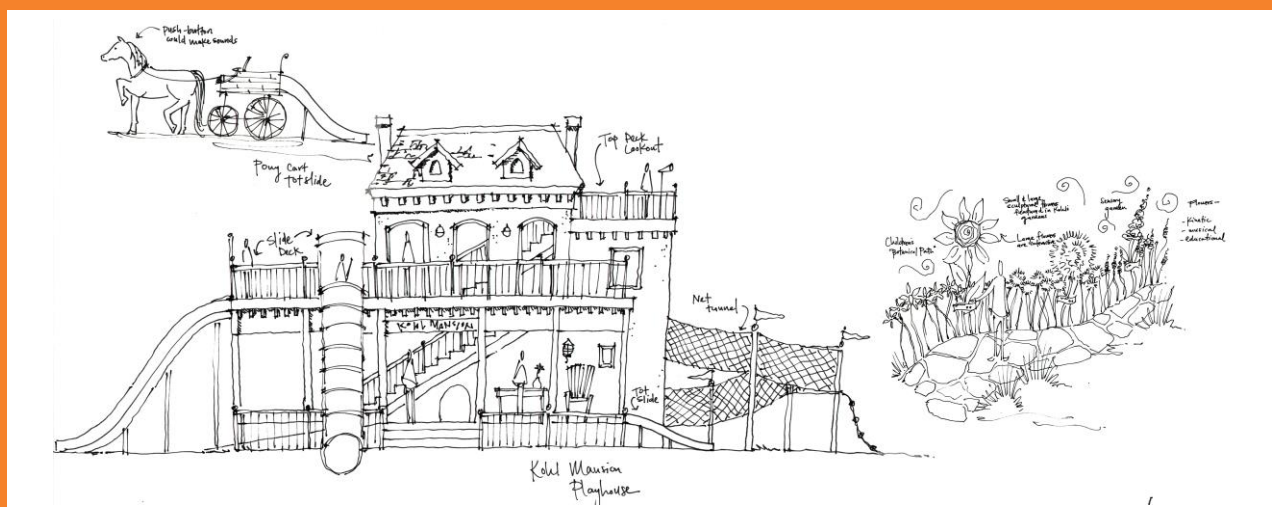

# INITIAL CONCEPT SKETCHES





Boardwalk in the Trees



Tower with Slide



Tall Swings

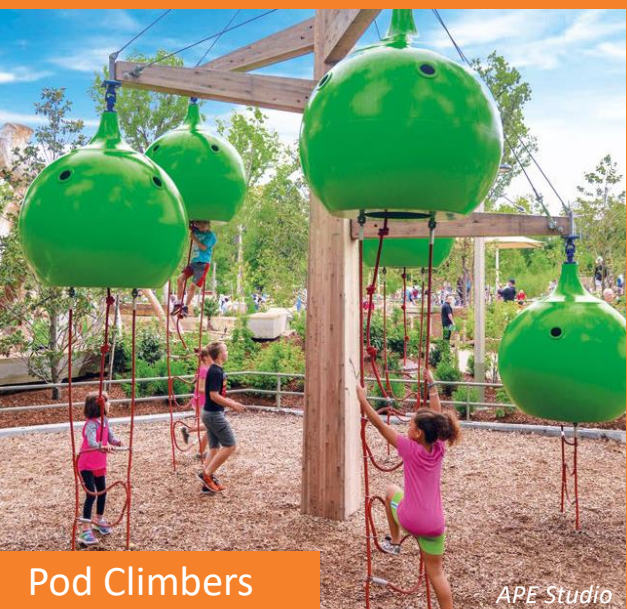

Pod Climbers



Whimsical Treehouse



Sand/Water Play



Play Creatures

# ADVENTURE VILLAGE - CHARACTER





Rope Tunnel

APE Studio

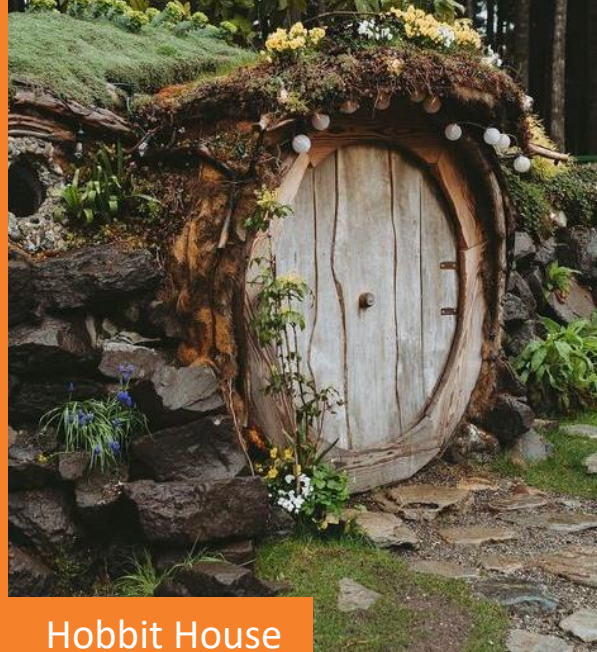

Hobbit House

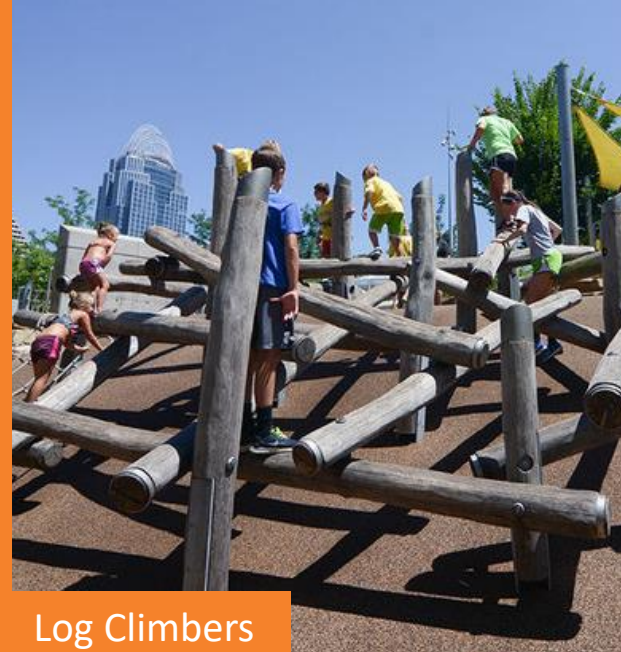

Log Climbers



Icon

Leaf Shade Sculptures



DWL

Fairy House



Cheerup

Thicket Hut



ID Sculpture

Stone Climbers



Group Picnic Shelter

# ADVENTURE VILLAGE - CHARACTER





# ADVENTURE VILLAGE CONCEPT PLAN



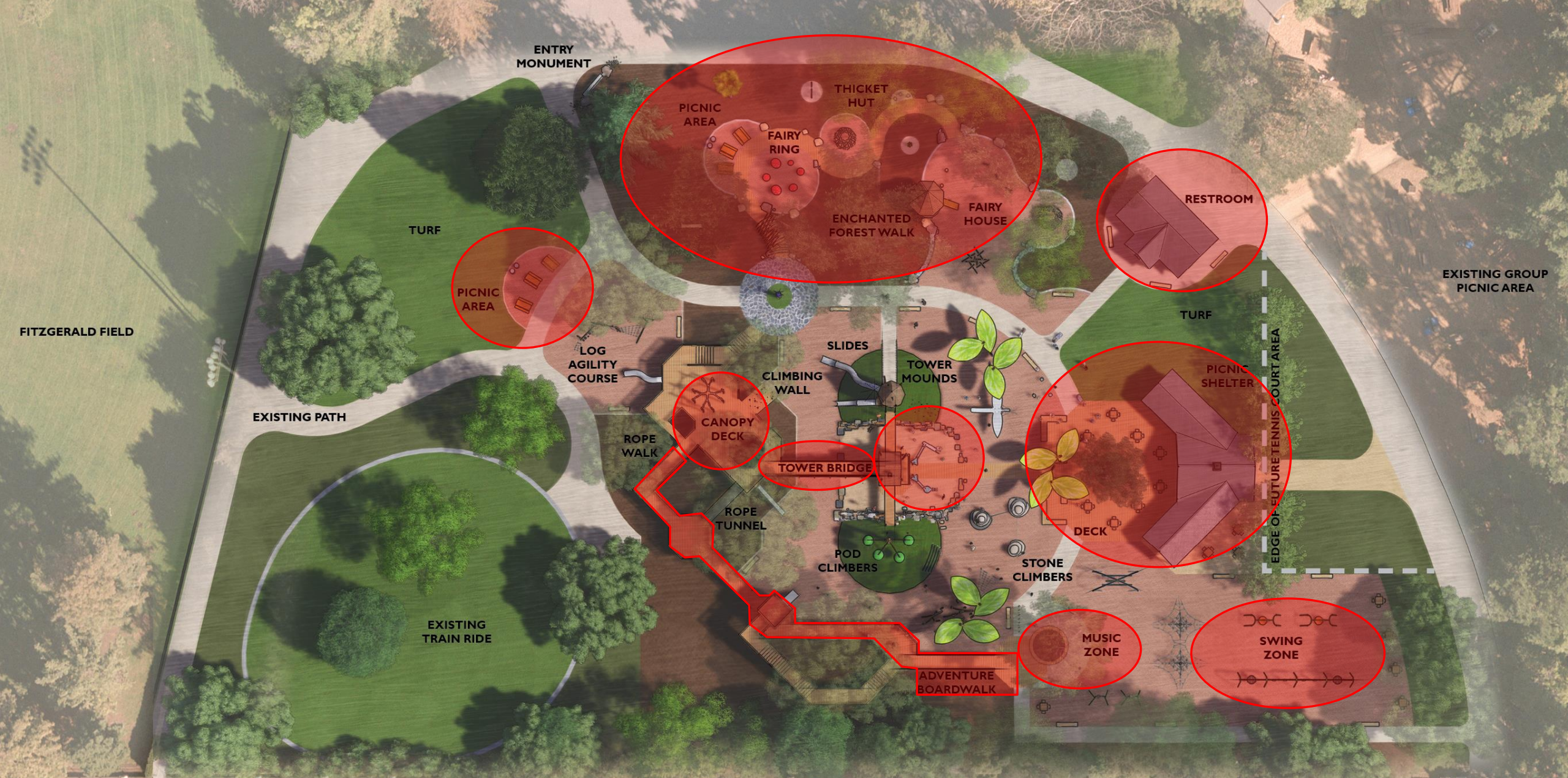

# ADVENTURE VILLAGE: ACCESSIBLE ELEMENTS

















Playhouse Structure



Zipline

APE Studio



Tot Playhouse

Monstrum



Dramatic Play

Monstrum

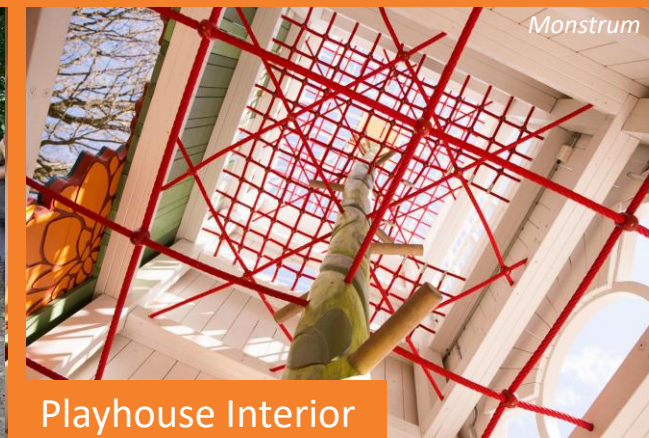

Monstrum

Playhouse Interior



Imaginative Play

Monstrum



Sculptural Climbers

Berliner

# PLAYFUL HISTORY - CHARACTER





Music Garden



Percussion Play



Wood Pergola

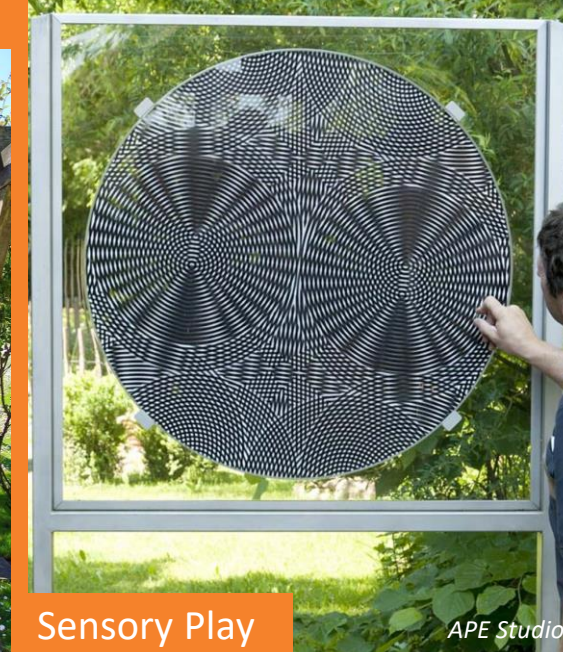

Sensory Play

APE Studio



Game Tables

APE Studio



Combination Swings

Goric



Water Table

Vortex



Sculptures



Carousel

# PLAYFUL HISTORY - CHARACTER





# PLAYFUL HISTORY CONCEPT PLAN



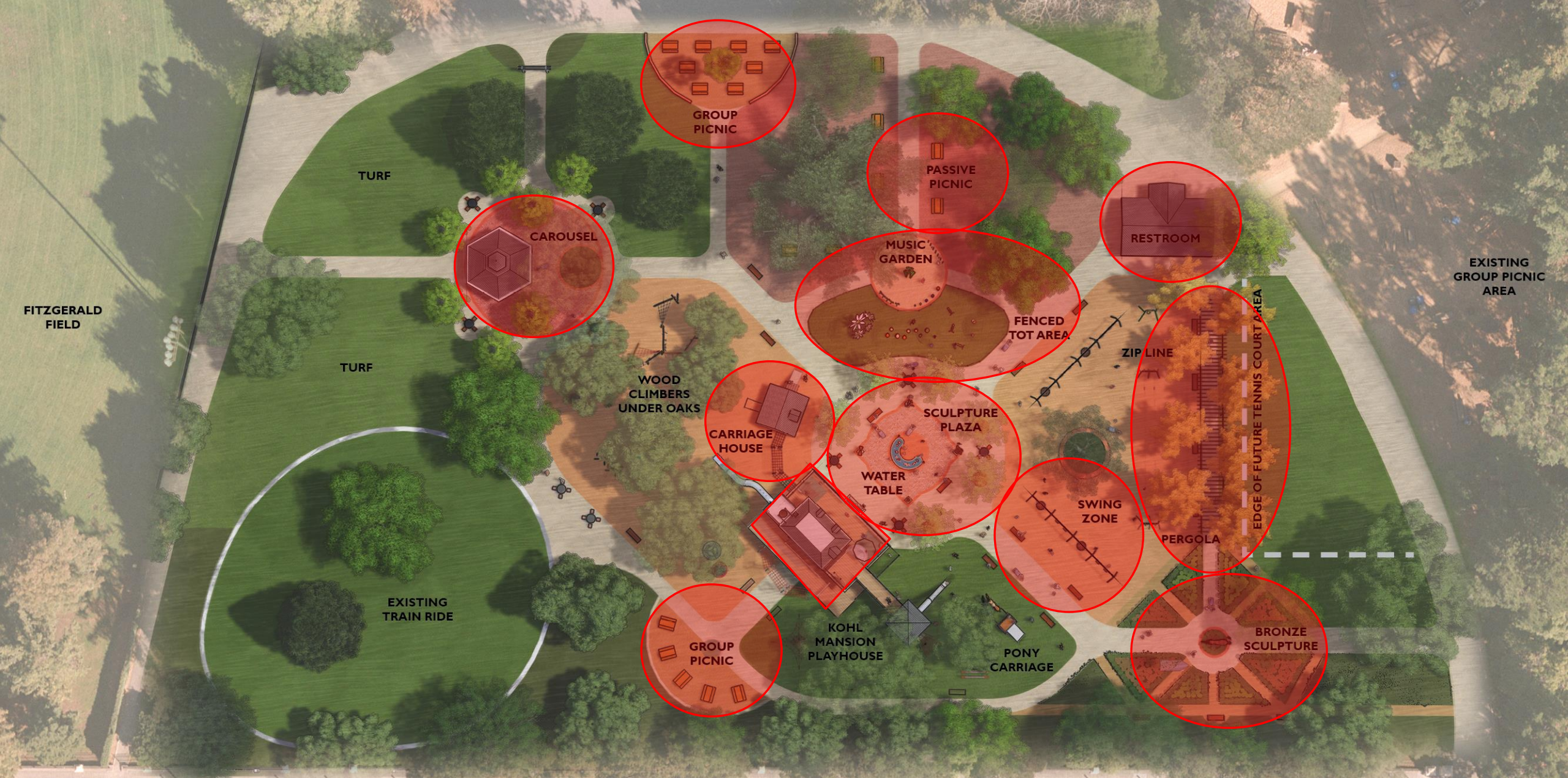

# PLAYFUL HISTORY: ACCESSIBLE ELEMENTS













# COMMUNITY DISCUSSION

*Using Google Sheets & Slido*



# TWO WAYS TO JOIN SLIDO

Go to Slido by:

Web Browser: slido.com

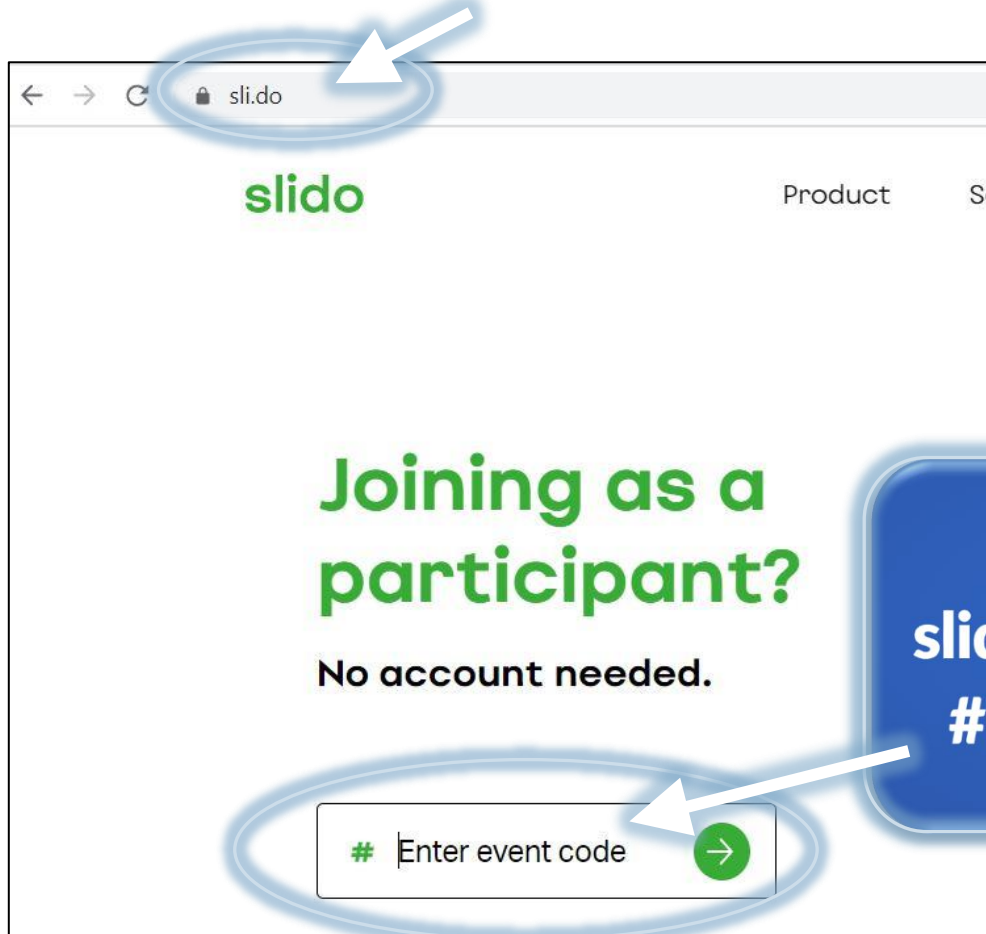

OR

Access QR Code







# CONCEPT OPTION – ADVENTURE VILLAGE





What are your favorite features of Adventure Village?

 Start presenting to display the poll results on this slide.





# CONCEPT OPTION – ADVENTURE VILLAGE





What would make the Adventure Village design even better?

 Start presenting to display the poll results on this slide.



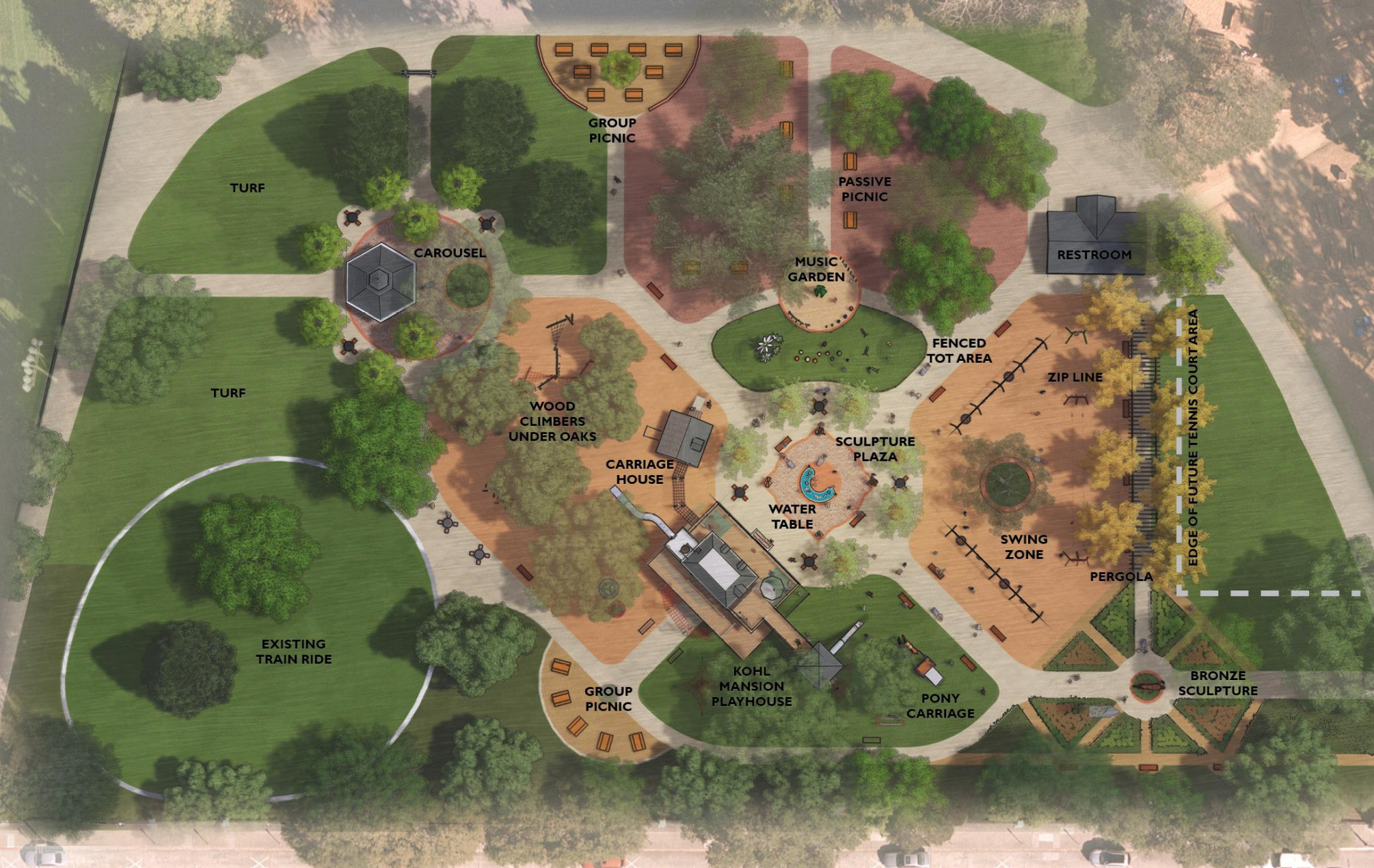

**CONCEPT OPTION - PLAYFUL HISTORY**





What are your favorite features of Playful History?

 Start presenting to display the poll results on this slide.



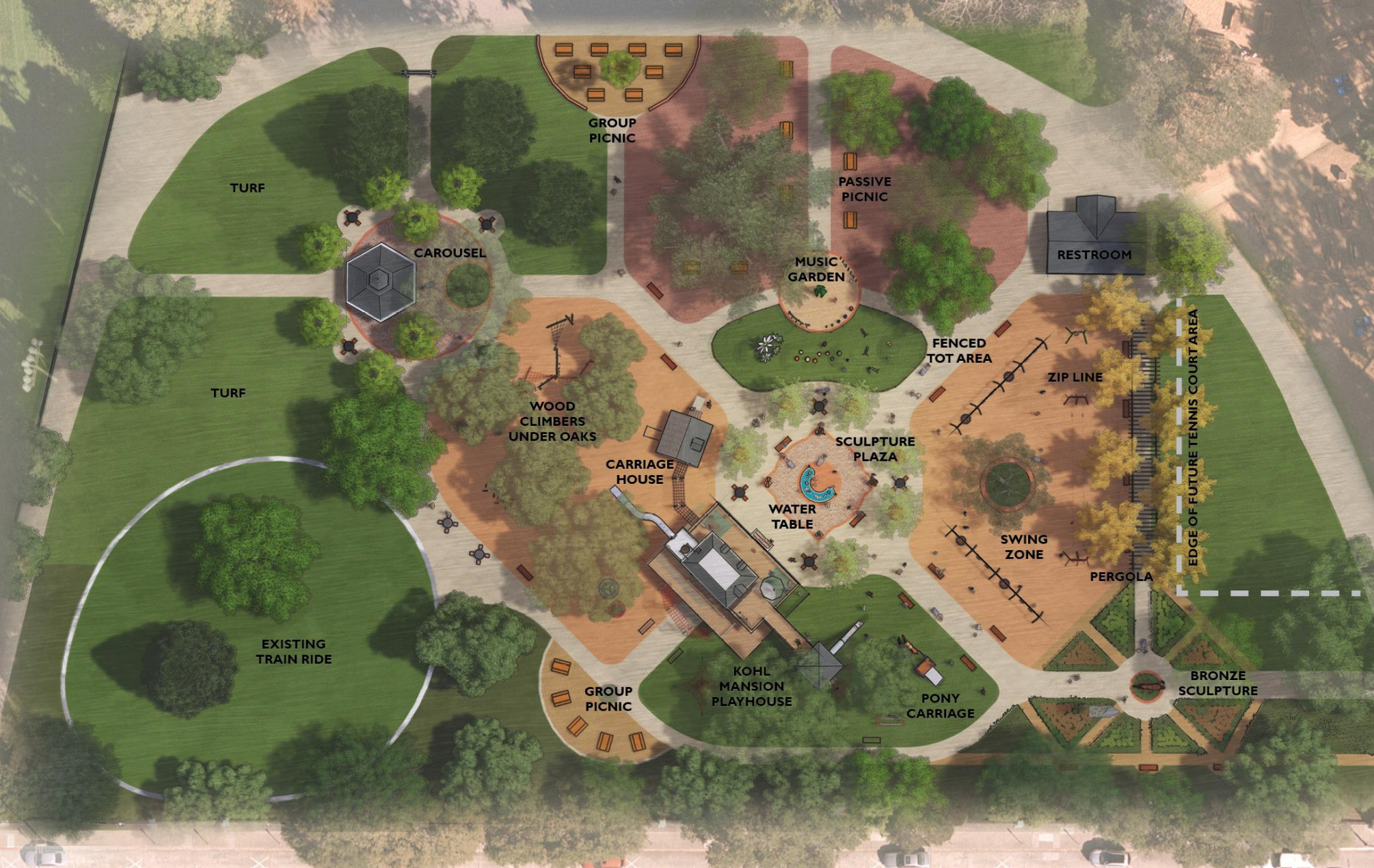

# CONCEPT OPTION - PLAYFUL HISTORY





What would make the Playful History design even better?

 Start presenting to display the poll results on this slide.



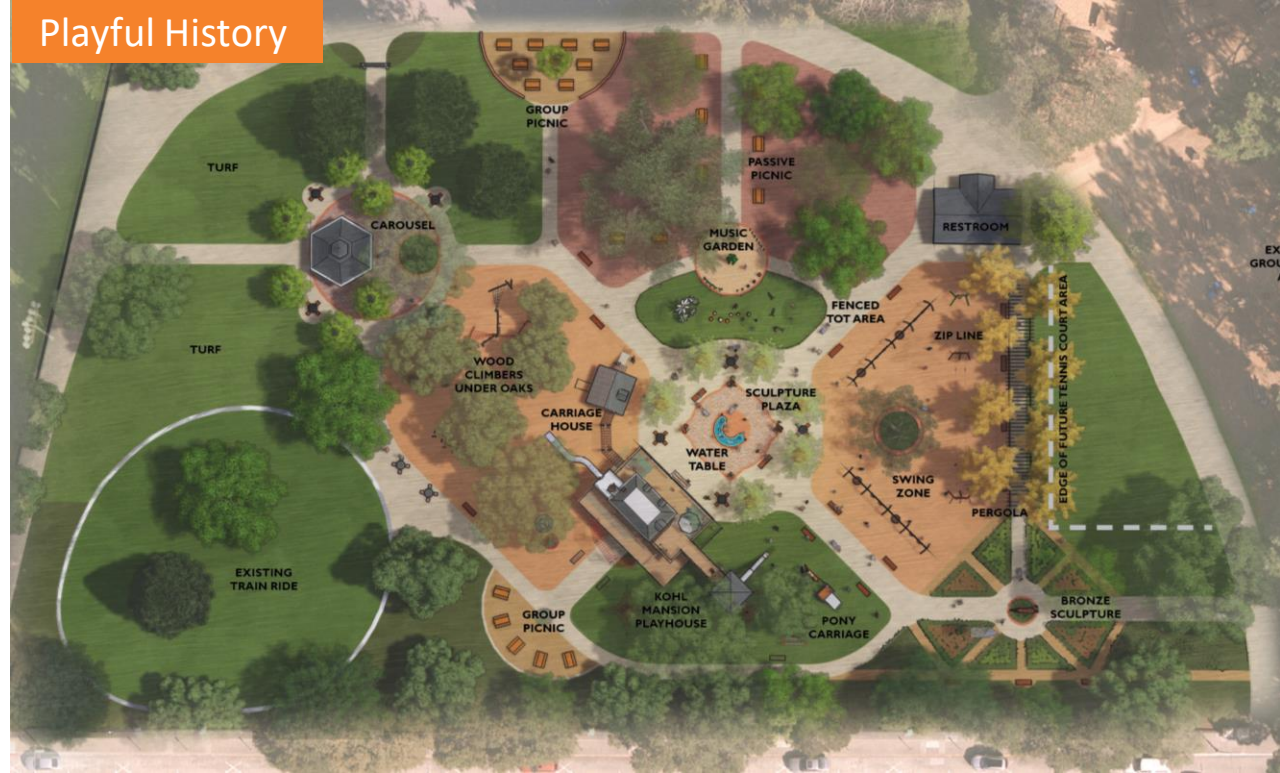
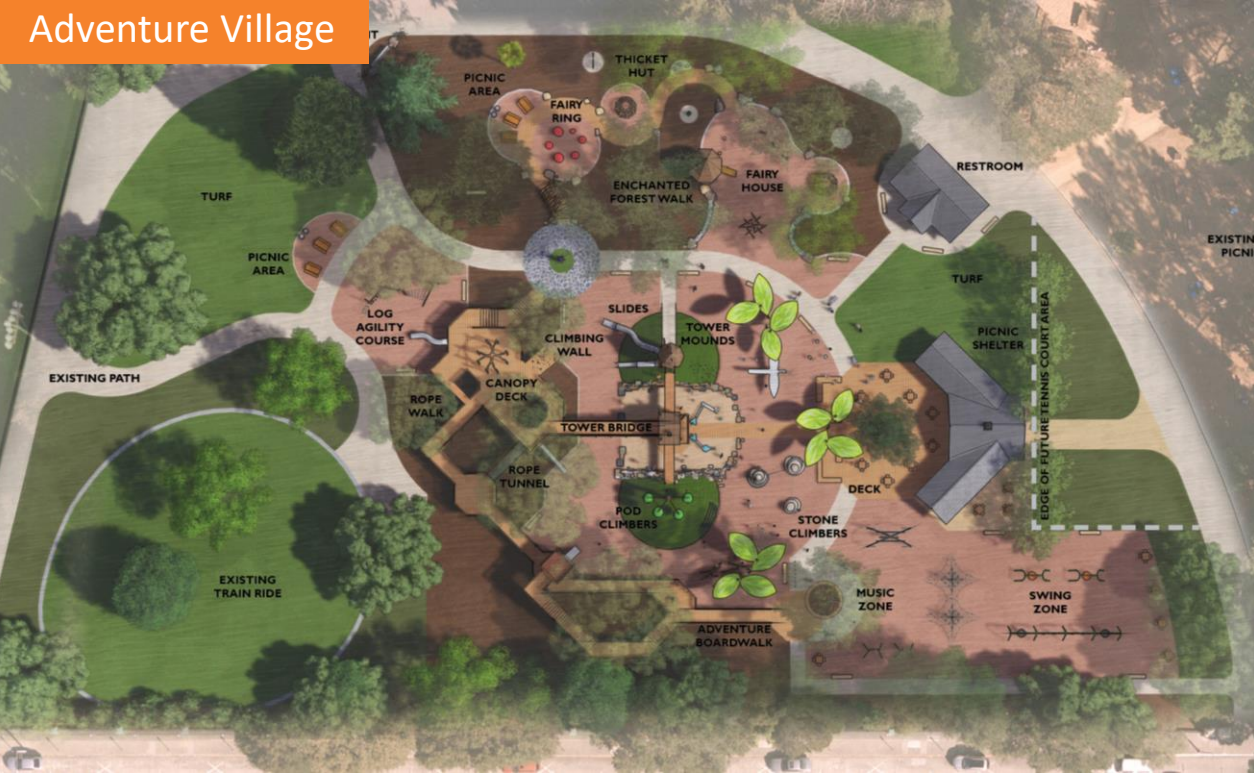

# CONCEPT OPTIONS





Which playground design do you prefer overall?

 Start presenting to display the poll results on this slide.





# NEXT STEPS

**Take the Survey:**

<https://www.cityofsanmateo.org/4142/Central-Park-Playground-Renovation>